



Technical Data	DOM Tapkey Guardian
Technology:	<ul style="list-style-type: none"> 13,56 MHz Mifare
Power Supply:	<ul style="list-style-type: none"> battery pack with 2 lithium cells 3,0 Volt type CR2 (Li-MnO₂ system)
Battery life time and data preservation:	<p>at room temperature (+20°C):</p> <ul style="list-style-type: none"> up to 20.000 locking cycles <u>or</u> up to 3 years by typical 10 use per day <ul style="list-style-type: none"> multilevel alarm system in case of voltage drop 10 years data preservation without battery
Time / Date:	<ul style="list-style-type: none"> buffering typically 1 minute (in case of battery change) clock drift at room temperature: ±10 minutes/year at -25°C and +70°C: -50 minutes/year
Signalling:	<ul style="list-style-type: none"> optical signalling (red/green/blue) circular lighting segments in outer fitting illuminated DOM logo
Clutch duration:	<ul style="list-style-type: none"> Adjustable ranging from 1 to 30 seconds
Inductive transponder interface:	<ul style="list-style-type: none"> reading range: up to 3 cm frequency: 13,56 MHz field strength in 10 m distance: < 42 dB µA/m in conformity with ETSI EN 300 330 supports passive transponders according to ISO 14443 A supports NFC according to ISO/IEC 18092 encryption: - Mifare DESFire EV2: AES-128 Bit
Transponder types:	<ul style="list-style-type: none"> DOM Standard Tac
Programming:	<ul style="list-style-type: none"> Programming via NFC Android Device; Android 4.4 or higher Google ID or Tapkey ID required
Events:	<ul style="list-style-type: none"> ring buffer for the latest 1.000 events
Approvals and certifications:	<ul style="list-style-type: none"> In conformity with all applicable EC directives National laws have to be checked separately Suitable for use in fire-proof doors T30 (test according to DIN EN 1634-1) Suitable for use in fire protection and smoke protection doors (tested according to P-120003866.02; MPA NRW)
Environmental:	<ul style="list-style-type: none"> Temperature: -20°C to +65°C Humidity: 20% to 99% no condensation Protection class: IP52





Technical Data

DOM Tapkey Guardian

Mechanical function::

- Electronically controlled handle on the outside
- Interior handle is always operable
- Exterior handle is pivot-mounted

Door leaf thickness:

- 34-114 mm, increment in 10 mm steps

Lock compatibility:

- mortise locks (latch operation: lock follower rotation by 5°)

Handle angle:

- 45°

Handle spindle:

- 9mm (with adapter 7 / 8 / 8,5 / 10 mm)

Exterior handle:

mitre handle

double-mitre handle

U-shaped handle

U-shaped, cranked

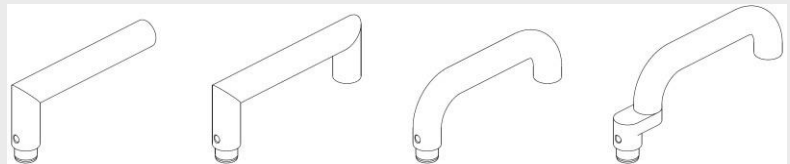

Maximum dimensions

50 x 130 mm

50 x 140 mm

50 x 140 mm

61 x 160 mm

Interior handle:

mitre handle

double-mitre handle

U-shaped handle

U-shaped, cranked

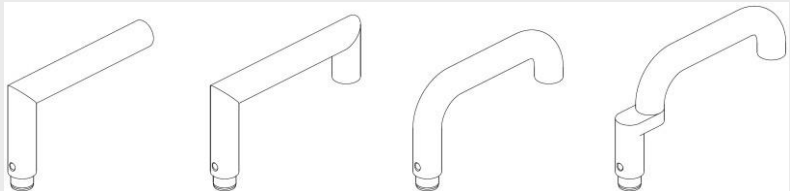

Maximum dimensions

72 x 130 mm

72 x 140 mm

72 x 140 mm

83 x 160 mm

Surface:

- Polished and satin stainless steel

Weight:

- Approx. 1.100 g (exterior fitting including handle)





Technical Data

DOM Tapkey Guardian

Dimension (W x H x D):

- Exterior fitting:
38mm x 260mm x 23mm (without handle)
- Adapter plate for renovation:
55mm x 277mm x 3mm (without handle)
- Interior fitting:
35mm x 250mm x 8mm (without handle)

Screw fitting:

- According to after-drawing:
DE1: dimension B = 75,5 mm FR: dimension B = 65mm
dimension C = 134,5mm dimension C = 130mm

Versions:

Distance dimension A	Cylinder profiles			
	PZ ¹⁾	PRZ ²⁾	RZ ³⁾	FRZ ⁴⁾
According to After draing				
	Ø17 mm	Ø22 mm	Ø22 mm	Ø26 mm
55	x	o	o	o
70	x	o	o	x
72	x	o	o	o
74	o	x	x	o
78	x	x	x	o
85	x	o	o	o
88	x	o	o	o
90	x	o	o	o
92	x	o	o	x
94	o	x	x	o
blind	x	x	x	x

¹⁾ Euro profile cylinder
²⁾ Profile round cylinder r
³⁾ Swiss round cylinder
⁴⁾ Dény round cylinder

x = available
 o = not available

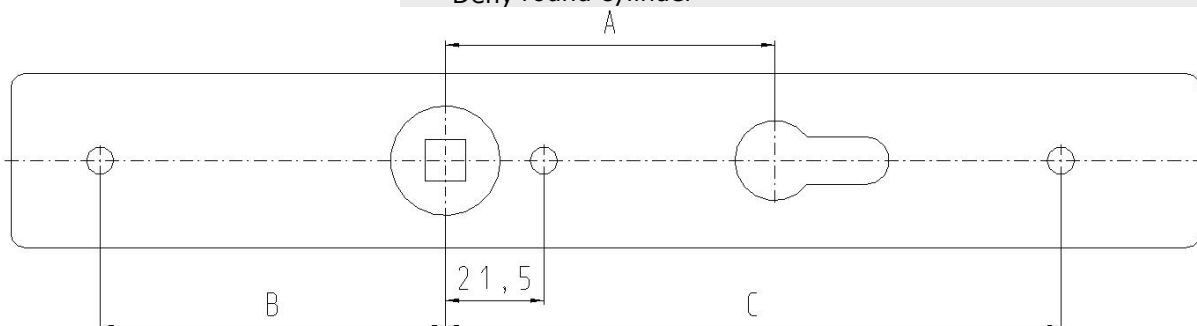

Battery note:

Existence of fire, explosion and burn hazard. Do not recharge, short circuit, crush, disassemble, heat above 85°C, incinerate or expose contents to water.



These data correspond to the actual development status and are subject to change at any time without notice.